

THIRD FLOOR

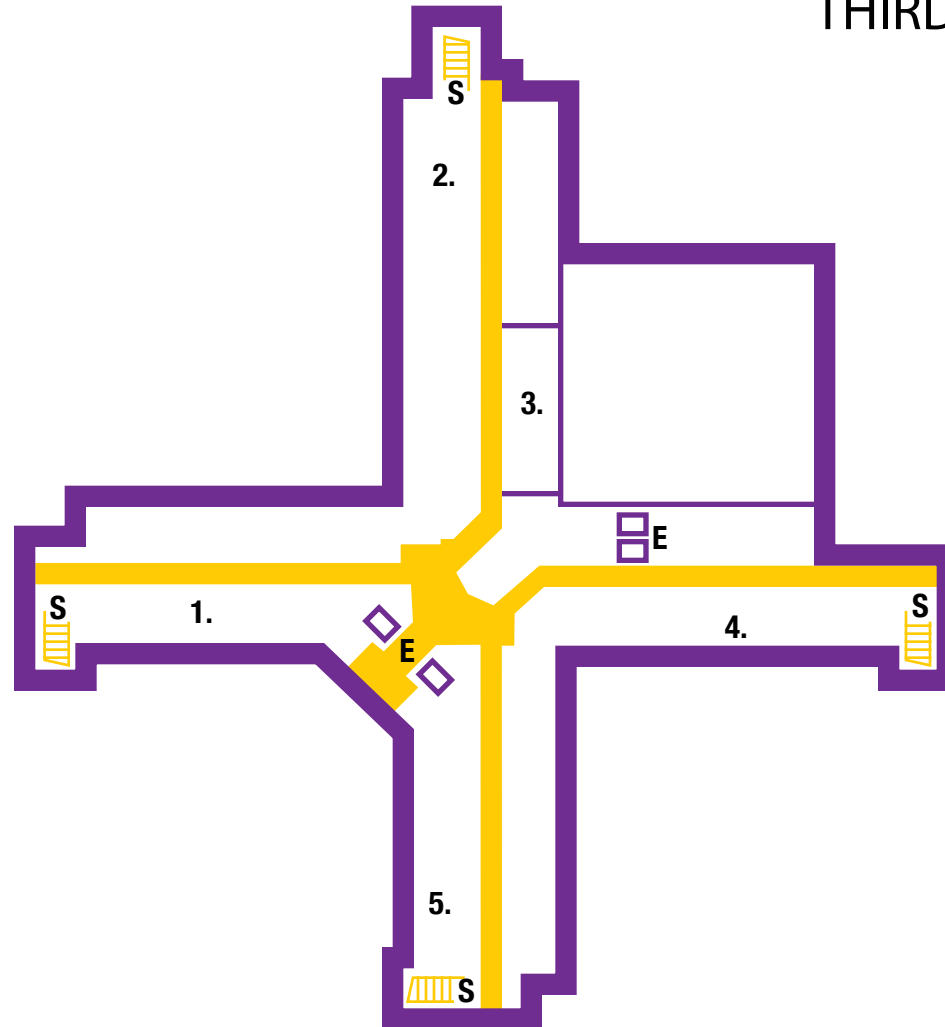

- 1. Medical/Surgical 3 West
Rooms 315-327
- 2. Medical/Surgical 3 North
Rooms 328-341
- 3. NMSU Education Center
- 4. Pediatric Unit 3 East
Rooms 342-351
- 5. Medical/Surgical 3 South
Rooms 301-314



- E - Elevators
- S - Stairs
- R - Restrooms